

Technical fact sheet

Information panels

Signage



Printed panels (printing following approval of the design proof*)

GS2423

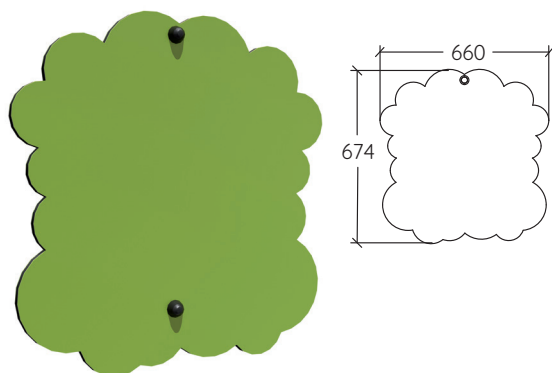

GS2405

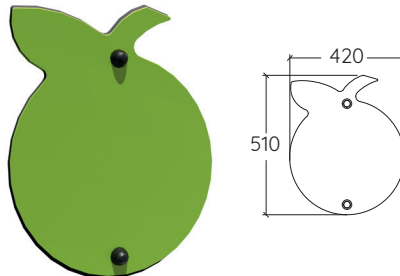

GS2420

(Playground signage)



GS2424

(Sports area signage)



Print examples
(white substrate)

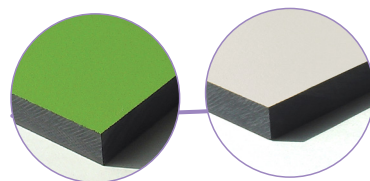

MATERIAL

COMPACT COMPOSITE PANELS

The GS2423, GS2405, GS2420, GS2424 and GS2410 panels are engineered from a 13 mm-thick composite compact laminate material, made from 70% soft wood fibre and 30% phenolic binder. **This material offers high levels of dimensional stability over long period.**

Engraved panels

(engraving following approval of the design proof*)

GS2410



Engraving examples
(background colours
subject to availability)

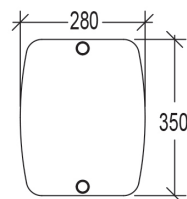

GS2420, GS2424 and
GS2410 dimensions

Printed panel

GS2440

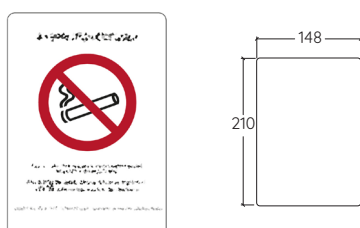

DIBOND®

The GS2440 panel is engineered from **DIBOND®**, a sandwich composite material made from two aluminium cover layers and a black polyethylene core, which guarantees long-term stability for outdoor applications. **This 4 mm-thick material is lightweight, but extremely stable and rigid.** Its alloy offers high resistance to corrosion and UV light.

*Information checked by the customer (print or engraving)